

Hooped Cable RGO Assembly Instructions

Notice: The following instructions assume you are experienced with the fabrication of RGO's. If you are not, or if you need additional assistance, please contact Fillauer, Inc., and request the technical manual "Reciprocating Gait Orthosis: A Pictorial Description and Application Manual." Fabrication courses are also available.

RGO Assembly

1. Insert joint nut (I) into upper hip joint bar (H) on slotted side of bar.
2. Lube spacer (F) and then slide onto end of joint nut (I).
3. Slip coupling plate (E) onto spacer (F), making sure flat side of plate is against bar (see figure).
4. Lube thrust bearing (B) and slide onto end of joint nut (I).
5. Slide thrust race (C) and place it into counter bore area of lower bar assembly head (D).
6. Place flat side of lower bar assembly (D) onto end of joint nut.
7. Lube thrust race (C) and place it into counter bore area of lower bar assembly head (D).
8. Place remaining thrust bearing (B) on top of thrust race (C).
9. Coat threads of joint screw (A) with Loctite #242 and screw into joint nut (I) until it reaches bottom, then turn joint screw (A) an additional one-quarter turn. Some additional adjustments may be needed to eliminate any "play" between the upper and lower bar assemblies and to ensure that bars rotate freely without binding.
10. Coat threads of set screw (G) with Loctite #242 and then screw into upper hip joint bar (H) to secure joint screw (A).

Cable Assembly to RGO

11. Insert one of the swivel nuts (J) into opening of swivel coupling (K) and screw the anterior cable with threaded terminal (M) into swivel nut. Repeat process for posterior cable (O).
12. Slide cable housing (N and P) over cables.
13. Repeat step #11 for opposite side.
14. Attach the "short" cable (O) to posterior side of coupling plate (E) with the provided screw (L) and nut* (Q).
15. Attach the "long" cable similarly, except to the anterior side of coupling plate.

* Medium and large only, Small cable assembly does not have a nut.

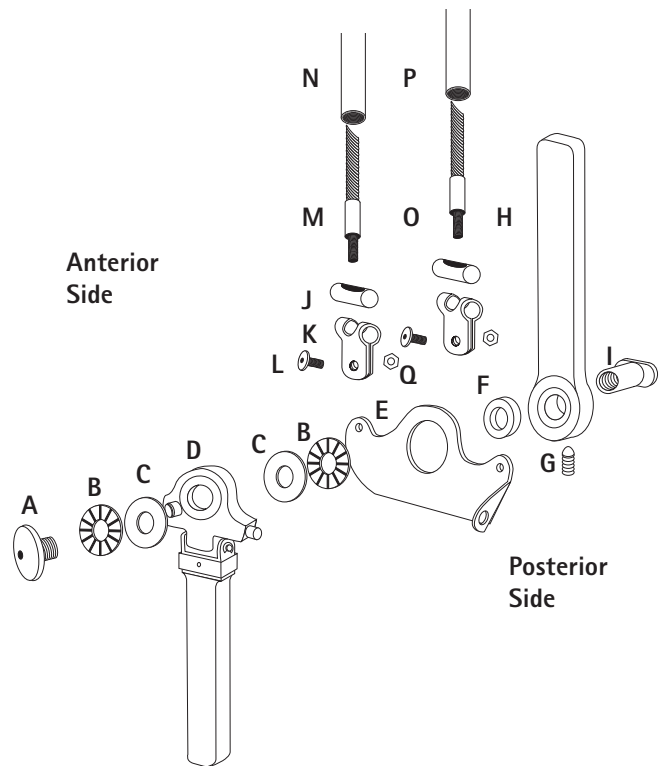

Fillauer.llc

2710 Amnicola Highway • Chattanooga, TN 37406 • Tel: 800.251.6398 • Fax: 423.629.7936 • www.fillauer.com
Centri® • Kung Hans Väg 2 • 192 68 Sollentuna, Sweden • Tel: +46 8 505 332 00 • Fax: +46 8 505 332 05 • www.centri.se

CE

PM108/03-01/07-03