

MC ETD Wrist Disarticulation

Prosthetist Manual

Motion Control
division of
Fillauer[®]

MC ETD Wrist Disarticulation

Prosthetist Manual

Introduction

The Wrist Disarticulation option provides an attachment plate that can be laminated directly to the outer socket of the prosthesis. This minimizes the length of the prosthesis in cases where much of the patient's remnant limb has been saved. While it does allow a slight amount of rotational adjustment, it sacrifices passive rotation and interchangeability of terminal devices for the patient.

Components

Figure 1

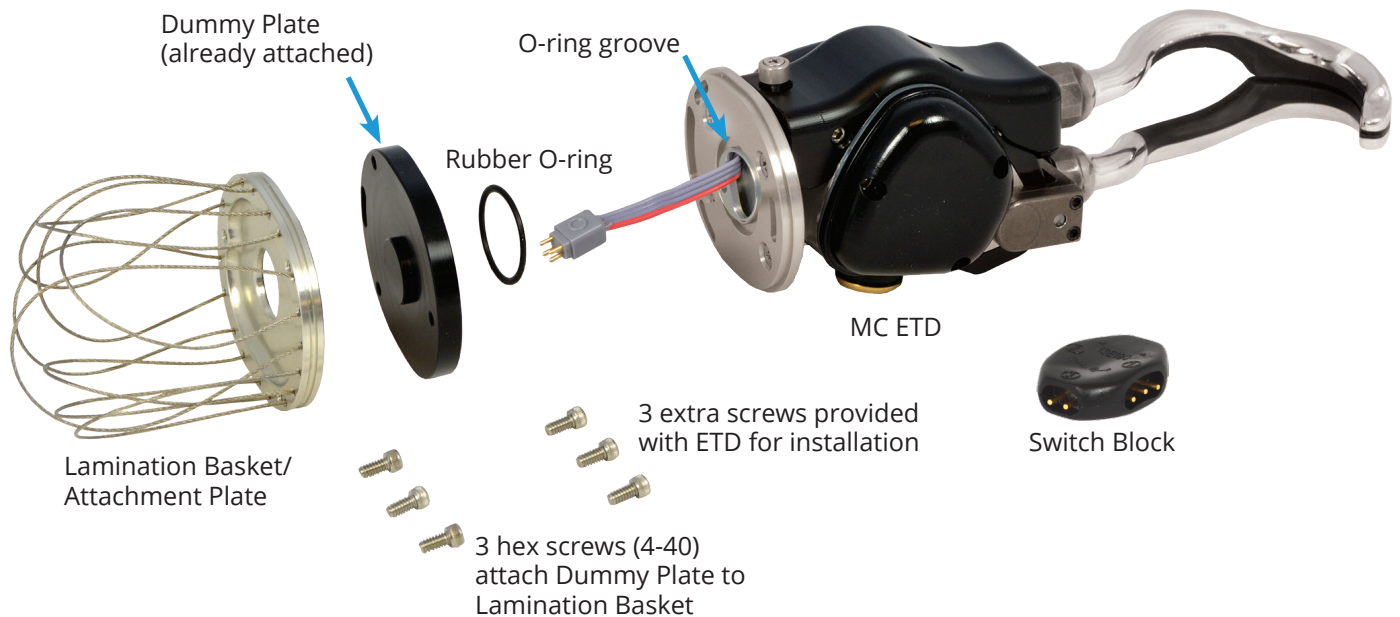

Instructions

1. Using foam, plaster of Paris, wax or other preferred material, shape the distal portion of the forearm. Ensure that the inner socket can be removed from the outer socket to allow installation of electrodes, preamps, wires, and internal battery.
2. Establish the mounting surface for the Lamination Basket. This must be at the correct length and wrist angle.
3. If necessary, use a parting agent (such as a PVA bag) between the forearm material and the Lamination Basket. This will allow easy removal of material, and removal of the inner socket from the outer forearm.
4. Temporarily attach the Lamination Basket, making sure the "TIPS" marking on the Lamination Dummy Plate (already installed) is in the direction of the MC ETD fingertips (Figure 2). Otherwise the lamination basket will be off by 180 degrees.
5. In the lay up, make sure at least 2 stockinettes (4 layers) are firmly tied off in the Tie-Off Grove.
6. Remove and add parting agent to each of the 3 hex screws holding the lamination dummy in place.
7. Reinstall the Lamination Dummy Plate and screws.
8. Laminate.

Figure 2

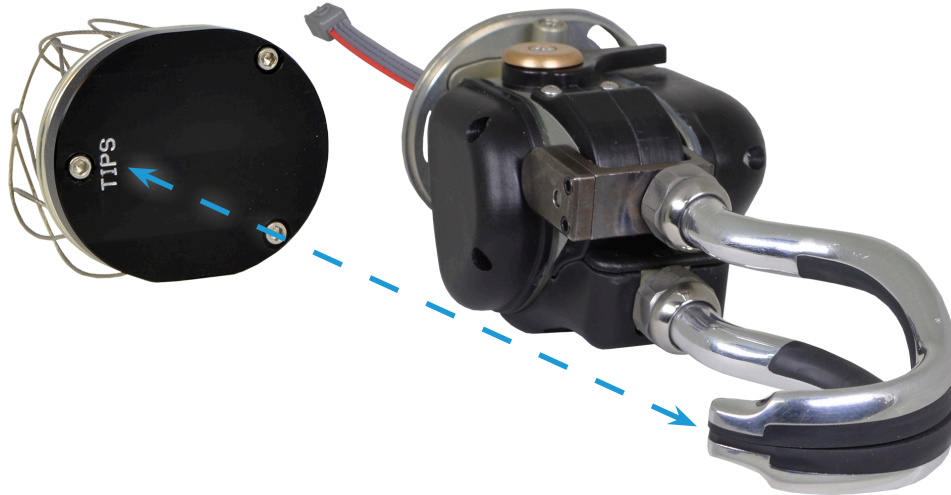

9. Trim the excess lamination away and remove the screws and the lamination dummy. Use care in removing the last piece of plastic to prevent damage to the attachment plate.
10. Slide the O-ring over the connector and into the groove on the MC ETD (Figure 1). A small amount of silicone grease will help hold it in place.
11. With the inner socket removed, feed the wire of the MC ETD through the center slot in the attachment plate.
12. Place a small amount of medium strength threadlocker (Loctite 242, 243 or equivalent) on the 3 hex screws packaged with the MC ETD. Use these screws to attach the MC ETD to the attachment plate. Note that the attachment holes are slotted to allow some rotational adjustment.
13. With a 3/32 in. ball end hex key, firmly hand-tighten the screws.

Other Information

Please see the enclosed MC ETD Prosthetist Manual and User Guide for important Instructions, Cautions, Specifications, Warranty information, etc.

Declaration of Conformity

The product herewith complies with the Medical Device Directive 93/42/EEC guidelines, and is registered with the United States Food and Drug Administration (Registration No. 1723997).



Motion Control
division of
Fillauer®

www.UtahArm.com

Motion Control, Inc.

115 N Wright Brothers Drive
Salt Lake City, UT 84116
801.326.3434
Fax 801.978.0848