

The Detachable Night Splint

Suggested Method For Attachment

1. Loosen the hex head screw. (1)
This permits the medial clamp to swivel.
2. Back out thumb screw (2)
a distance sufficient to permit shoe to fit between the lateral and medial clamps.
3. Bend, twist or otherwise adjust the medial clamp and posts to best fit shoe sole.
 - A. Front post may need twisting (with pliers) so that the lip of the post may fully grip the shoe. (3)
 - B. When the heel is too thick to accommodate the rear post, notch the heel where the lip fits with a screw driver or a sharp instrument and force the lip into the notch. (4)
4. Hook lateral clamp to the sole just ahead of the heel and tighten thumb screw only moderately.
5. The large numbers on the wrench enable you to make the desired setting in terms of degrees. (See Illustration)

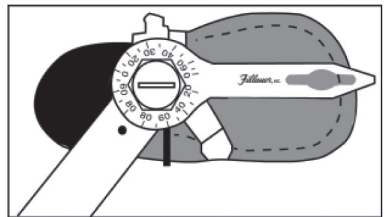
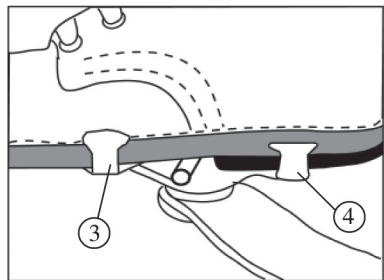
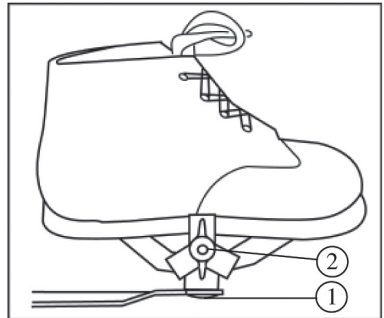

014233 Shoe Clamp Assembly

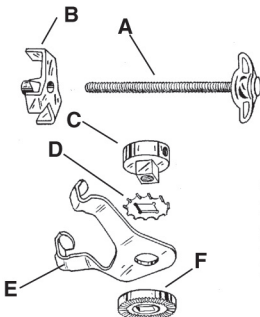

- | | |
|-----------|----------------------------|
| A. 801621 | Thumb Screw |
| B. 801548 | Prong Clamp |
| C. 801589 | Center Nut |
| D. 801522 | Lock Washer |
| E. 801563 | Wide Jaw Medial Shoe Clamp |
| F. 801688 | Serrated Washer |

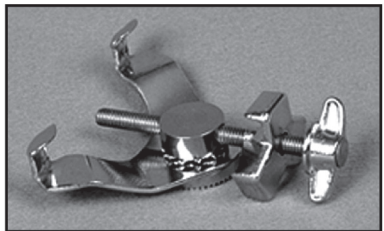

Fillauer LLC

P.O. Box 5189 • Chattanooga, TN 37406

1-800-251-6398

Fax 423-624-1402

Email: fillauer@usit.net

www.fillauer.com



PM006/04-04/12-04